



VIVA 3.2

V-GROOVE

PERFECT CUTS AND JOINS



VIVA 3.2 IS THE FULLY-AUTOMATIC, INNOVATIVE COMPACT SOLUTION FOR CREATING V-GROOVES: 45° DOUBLE CUTS, TO PRODUCE 2 POLISHED PANEL SLABS THAT CAN THEN BE GLUED TOGETHER AT 90°.

MONTRESOR HAS ALWAYS BEEN SYNONYMOUS WITH EDGE POLISHERS.

Montresor edge polishers enable fast mass production of flat and bullnose edges, both on sheet materials and semi-finished products with various profiles. Over the years, Montresor has specialised in the manufacture of edge polishers, to meet the needs of operators creating finished products from materials such as marble, granite, porcelain and synthetic materials. Continuous technical and technological research has enabled Montresor to produce extremely functional machines that offer the very latest technologies, meeting the needs of both small stonemasons and large companies.

Montresor confirms its position as industry leader, with the introduction of a machine which can preform complementary 45° cutting operations.

Viva is the highly-productive **patented** Montresor solution dedicated to 45° cutting operations, including scoring, to facilitate panel gluing operations.

VIVA

- ▶ **Absolute quality and reliability guaranteed over time**
- ▶ **Maximum machining precision and stability**
- ▶ **Innovative patented system**
- ▶ **Practical and extremely easy to use**

ABSOLUTE QUALITY AND RELIABILITY GUARANTEED OVER TIME

Viva 3.2 is the fully automatic machine for performing v-groove cuts, an operation that is often required in the manufacture of kitchens and bathrooms. This solution represents the perfect response to the need to machine slabs of reduced thickness, and to glue a front plate onto the piece in question to increase the dimensions of the side of the machined slab.



A v-groove is a 45° double cut, to obtain 2 polished panel slabs that can then be glued together at 90°.

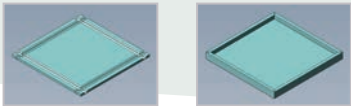

V-GROOVE
The V-Groove unit is composed of 2+2 disks which are positioned at 45° from one another when working. These disks cut the material, leaving 0.2-0.8 mm of uncut surface on the polished part of the slab.

- Fully automatic disk positioning
- Continuation of natural veining on the front part of the slab to be glued
- Slot cuts to facilitate assembly, with biscuit joint

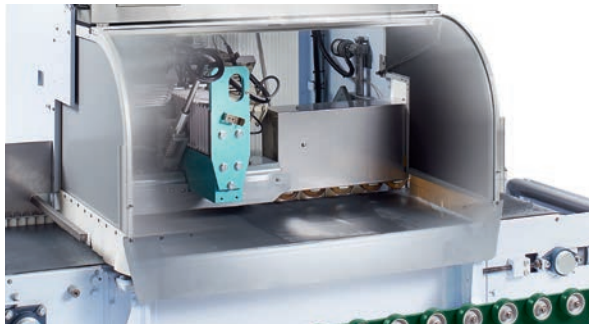

V-GROOVE UNIT: FULLY AUTOMATIC PATENTED SOLUTION.

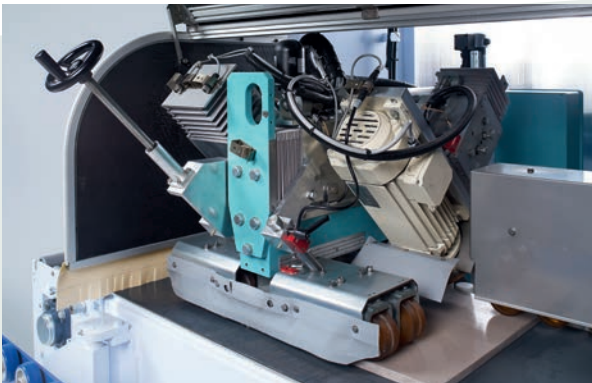

EXTREMELY EASY AND INTUITIVE.

The touch screen panel enables simple and automatic programming. Simplified operations when machining several perpendicular sides, with maximum joint angle precision.



The entire process is controlled by PLC, so all the operator has to do is set the cutting position that will determine the size of the front plate (up to a maximum of 220 mm).



TECHNICAL SPECIFICATIONS	
Total footprint (mm/inch)	2500x1800 98.42 x 70.86
Min. working length (mm/inch)	300 11.81
Min. working width (mm/inch)	225 8.85
Conveyor belt speed (mm/min - inch/min)	0 - 2200 0 - 86.60
Min/max installed power (kW)	10
Water consumption per minute (l/min)	80
Total weight (approx. kg - pound)	2300 6150

ALL IN ONE

THREE EXCELLENCES, ONE PARTNER.

Intermac, Donatoni Machine and Montresor, three leaders in the stone machining sector, combine skill, technology and a widespread distribution network to support customers in the creation of the intelligent factory, elevating the service provided in order to ensure 360° customer care.

MONTRESOR
EDGE POLISHERS - SINCE 1958

INTERMAC

DONATONI
HIGH INNOVATION STONE MACHINES

MONTRESOR.NET
INTERMAC.COM
DONATONI.EU

A COMPLETE RANGE OF SOLUTIONS FOR STONE

MONTRESOR
EDGE POLISHERS - SINCE 1958

HORIZONTAL EDGE POLISHER
FOR FLAT EDGES



Lola 6.4



Lola 8.6



Lola 10.8

FLAT AND BULLNOSE
EDGES



Luna 7.4



Luna 8.6

VERTICAL EDGE POLISHER
FOR FLAT EDGES



Vela 7.2

V-GROOVE



Viva 3.2

INTERMAC

WATER JET
CUTTING SYSTEMS



Primus 184



Primus series



Master 23



Master One



Master 33.3 - 38.3 - 45.3
Master 33.3 Plus-38.3 Plus-45.3 Plus



Master 33.5 Plus - 38.5 Plus - 45.5 Plus

UNIVERSAL
MACHINING CENTRES



Master 850-1200

UNIVERSAL AUTOMATIC
MACHINING CENTRES



Mastersaw 625 Double Table

CUTTING TABLES FOR
SINTERED MATERIALS



Genius RS-A

DOUBLE-EDGER
FOR SINTERED MATERIALS



Busetti F Series

STORAGE AND HANDLING
SYSTEMS FOR SINTERED
MATERIALS



Navetta Lite

TOOLS
FOR STONE



Diamut Tools

DONATONI
HIGH INNOVATION STONE MACHINES

BRIDGE
SAWS



Spin 625



Jet 625



Echo 725



Sprinter 825



Echo Twin



SX-3 / SX-5



Echo Belt

CUTTING
LINES

MULTIFUNCTIONAL CUTTING
CENTRES



Quadrix DV 1100



Quadrix DG 1300/1600/2000

UNIVERSAL CUTTING
CENTRES



Kronos 500/650/900

EDGE POLISHERS
AND CALIBRATORS



Zenit

SHEET LOADING/
UNLOADING

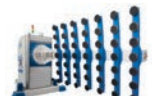

Geko

ROBOTS



Cyberstone

